

Profile

Parcel:	Q7SW2C 5 3 0715	Land Use Code:	110
Address:	880 NEW YORK AVE	LUC Description:	Single Family, Residential
Owner Details:	WEAVER JOS M & MARGARET A	Municipality:	HELLERTOWN BOROUGH
		NBHD:	1501
		School District:	SAUCON VALLEY SCHOOL DIST
Mailing Address:	C O BONNIE STOHL POA 214 CHERRY ST HELLERTOWN PA 18055	Zoning:	RESIDENTIAL LIGHT
		Land Acres:	0.1263
		Street/Road:	PAVED/SIDEWALK
		Topography:	LEVEL
		Utilities	ALL PUBLIC

Value Summary

Appraised Land:	34,100	Assessed Land	17,100
Appraised Building:	82,800	Assessed Building	41,400
Appraised Total:	116,900	Assessed Total	58,500

Primary Residential Card

Card:	1	Basement:	FULL	Fireplace Prefab:	
Stories:	1	Square Feet:	1138	Fireplace Opening:	1
Style:	RANCH	HT/AC:	NORMAL	Fireplace Stacks:	1
Year Built:	1957	Fuel:	ELECTRIC	Basement Garage:	1
Year Remod.		System:	WARM AIR	Grade:	C
Total Rooms:	5	Attic:	NONE	Cond (CDU):	GD
Bedrooms:	3	Rec Room Area:	0	Percent Complete:	
Full Bath:	1	Finished Basement Area:	0	Family Room:	0
Half Bath:	0			Ext. Material:	STONE

Commercial Card

Year Built	Improvement Name:
Units	Gross Floor Area:
Grade:	

Other Items

Code Description	Yr Blt	Sq Ft
RG1 FRAME OR CB	1987	600

Sales History

Date	Book-Page	Grantor	Sale	Desc	Parcels	Amount
1/1/1979	C100--000101		D	HISTORICAL DEED		

MAP

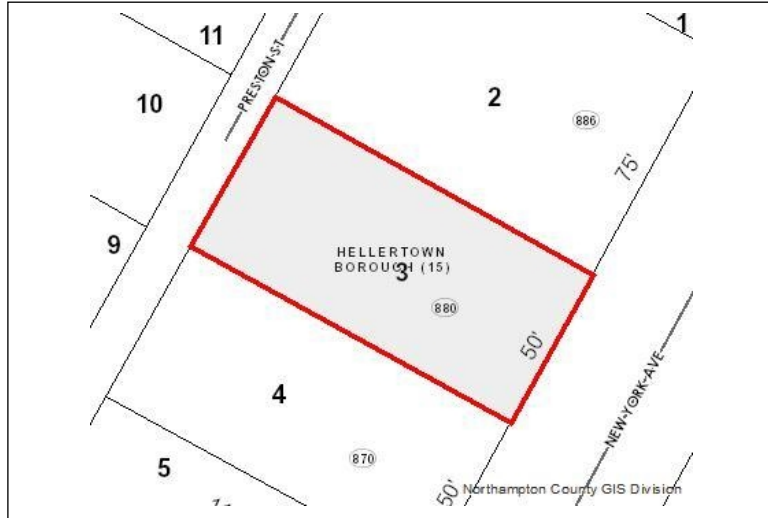

PHOTO



SKETCH

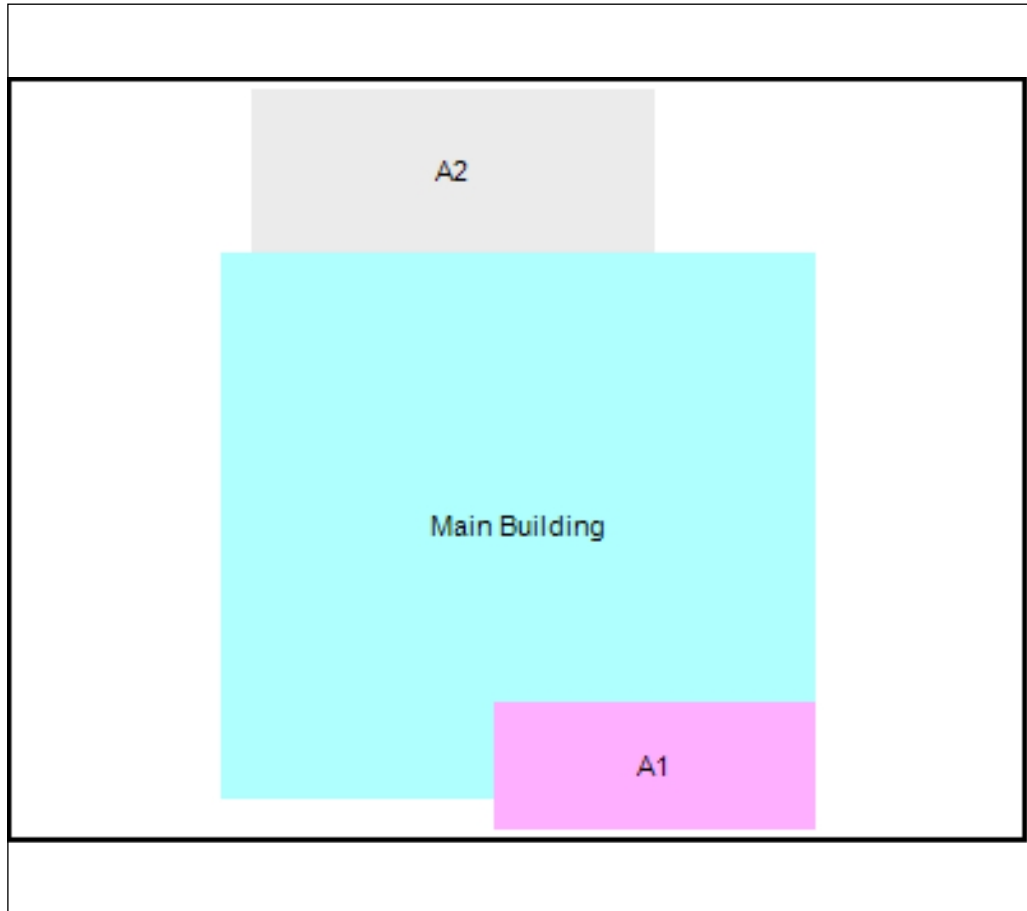

Sketch

- 0 Main Building 1138 Sq. Ft.
- 1 A1 - 11:OFP OPEN FRAME PORCH 160 Sq. Ft.
- 2 A2 - 11:OFP OPEN FRAME PORCH 250 Sq. Ft.
- 1 DET GARAGE - RG1:FRAME OR CB DETACHED GARAGE 600 Sq. Ft.